

## Horseshoe Court, EC1V



Positioned on the second floor of this incredibly popular modern development in the heart of Clerkenwell, is this well arranged two double bedroom apartment. With views towards Northburgh Street and Dallington Street, the apartment is finished to a high standard with an open-plan kitchen/reception, a large balcony which is accessed off the reception and master bedroom, two double bedrooms - the master with an ensuite, a further guest bathroom and good storage.

Brewhouse Yard is a courtyard development off St John Street, close to Farringdon and Barbican underground stations. It is perfect for access to local amenities such as Waitrose, Whitecross Street market, Hatton Garden and Smithfield. It is a short walk from both Barbican and Farringdon underground stations - the latter which is undergoing refurbishment for Cross Rail.

**Price: £499,995 Leasehold**

Flat 11,  
Horseshoe Court,  
11 Brewhouse Yard, EC1V

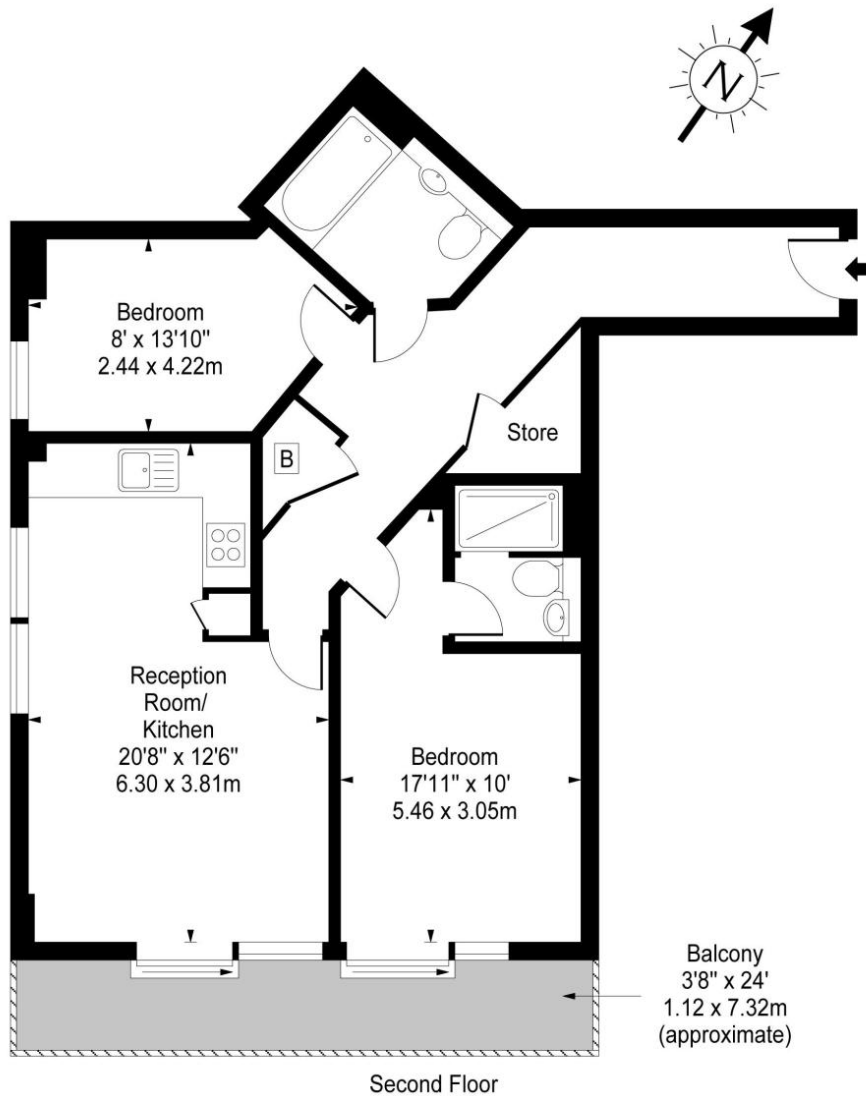

Approx Gross Internal Area **744 Sq Ft - 69.12 Sq M**

For Illustration Purposes Only - Not To Scale

Floor Plan by [www.pixandplans.com](http://www.pixandplans.com)

Ref. No.136

Important Notice: 1. These particulars are prepared for guidance purposes only. They are intended to give a fair overall description of the property but are not intended to constitute any part of an offer or contract. 2. Nothing in these particulars shall be deemed to be a statement that the property is in good structural condition or otherwise nor that any services, appliances, equipment or facilities are in good working order. 3. Whilst all information contained in these particulars whether in the text, plans or photographs is given in good faith, intending purchasers must make their own enquires as to the accuracy of all matters upon which they intend to rely.