

## Richmond Road, E8



A bright and spacious one bedroom flat situated on the top floor of this imposing Victorian building. Located in the heart of the London Fields conservation area, this flat comprises a large reception room, double bedroom and well fitted kitchen and bathroom. This property benefits from large sash windows and loft access, which offers a large amount of storage. Close to the open spaces of London Fields, with the refurbished Victorian Lido and Tennis courts, Broadway Market is also a short walk away, as is the new East London Line station at Dalston Junction, opening in 2010.

Price £249,950 Leasehold

# Richmond Road, Hackney E8

APPROX. GROSS INTERNAL FLOOR AREA 484 SQFT / 44.9 SQM

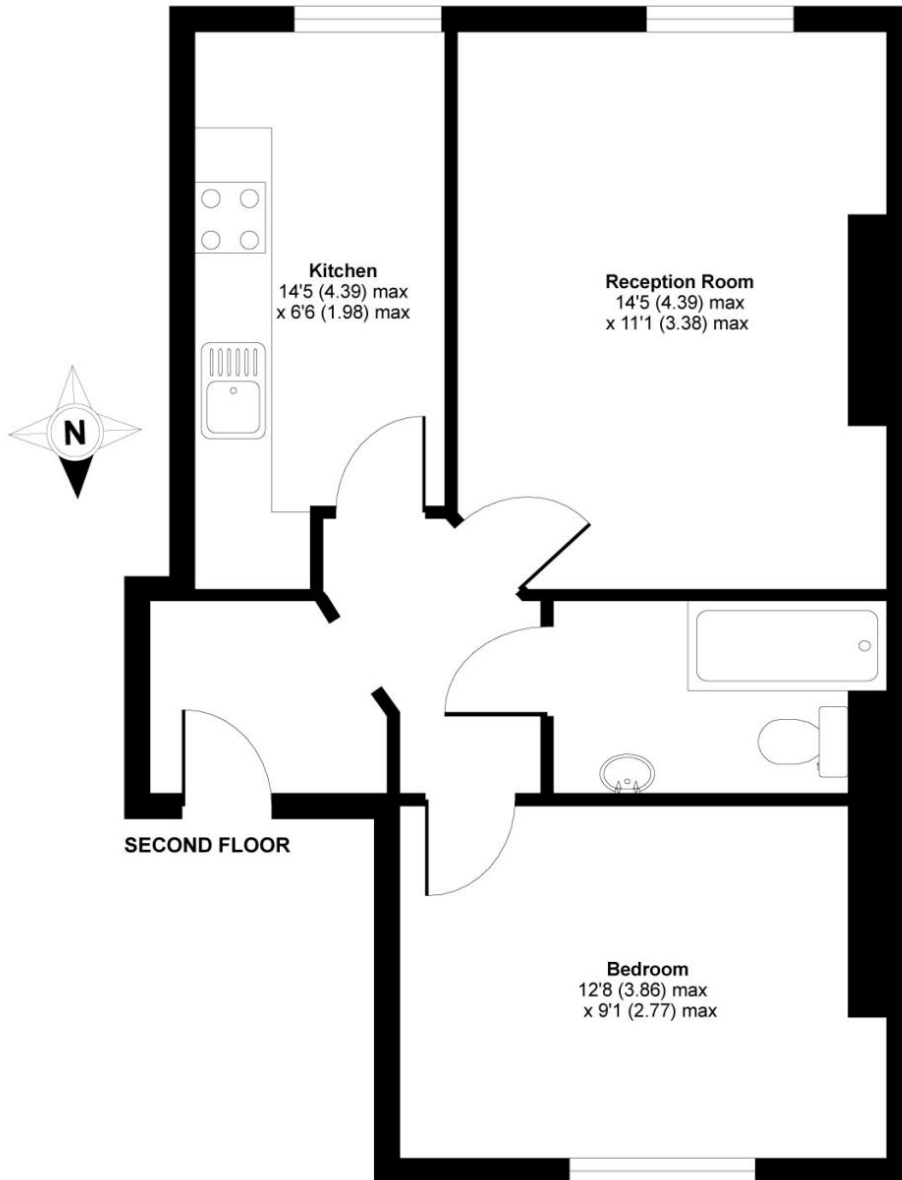

Whilst every attempt has been made to ensure the accuracy of the floor plans contained here, measurements of doors, windows and rooms are approximate and no responsibility is taken for any error, omission or mis-statement. These plans are for representation purposes only as defined by RICS Code of Measuring Practice and should be used as such by any prospective purchaser. The services, systems and appliances listed in this specification have not been tested by Currell Res.(Hackney) Ltd. and no guarantee as to their operating ability or their efficiency can be given.

Copyright nichecom.co.uk 2009 Produced for Currell Res. Ltd REF : NH097327

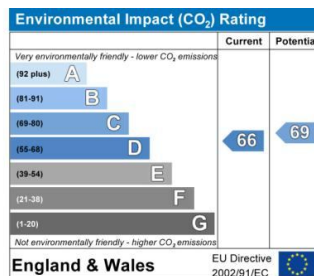
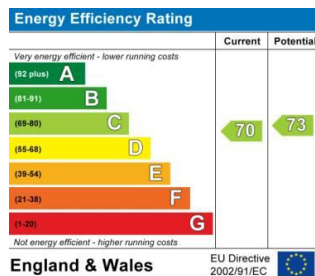

**Important Notice:** 1. These particulars are prepared for guidance purposes only. They are intended to give a fair overall description of the property but are not intended to constitute any part of an offer or contract 2. Nothing in these particulars shall be deemed to be a statement that the property is in good structural condition or otherwise nor that any services, appliances, equipment or facilities are in good working order 3. Whilst all information contained in these particulars whether in the text, plans or photographs is given in good faith, intending purchasers must make their own enquires as to the accuracy of all matters upon which they intend to rely.